

## Using your new Splendide combo is easy!

WDC7200XCD / WDV2200XCD

### Laundry Aid Dispenser

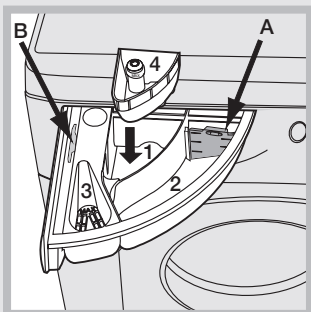

#### Chamber 1:

Prewash detergent\* (powder ONLY)

#### Chamber 2:

Powder or liquid HE detergent\* (Move plastic partition to **slot A** when using liquid or store in **slot B** when using powder.)

#### Chamber 3:

1-2 Tbsp. fabric softener

#### Extra Chamber 4:

Bleach

### IMPORTANT!

\*Use only High Efficiency (HE) detergent in the correct dosage for your machine (1-2 TBSP of powder detergent (or liquid equiv.) per load.

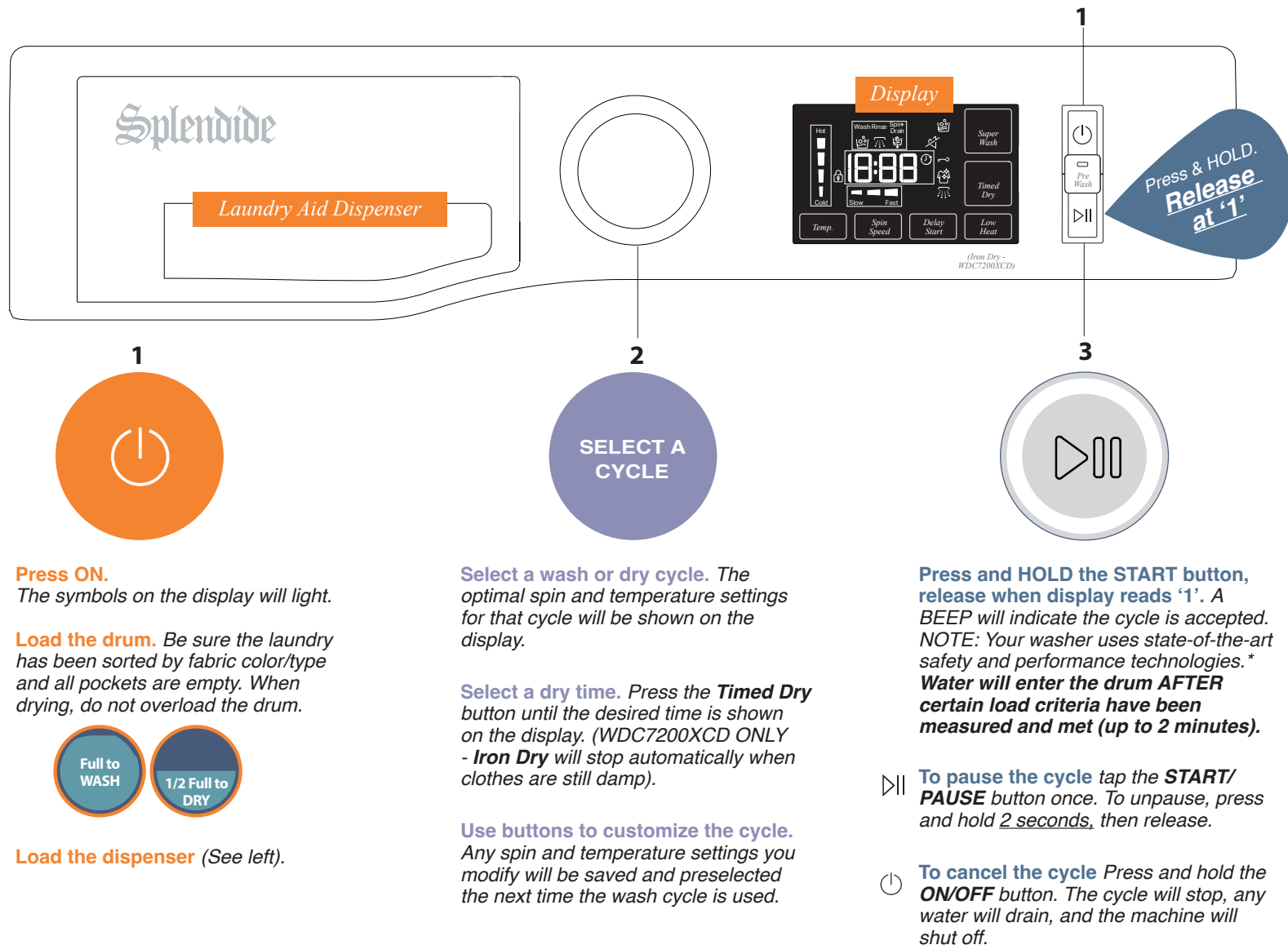

SEE BACK PAGE FOR 'CLEAN WASHER' AND 'WINTERIZATION' INSTRUCTIONS >>>

\*Unbalanced loads may increase wash cycle times. With two minutes remaining in the cycle: the display timer will pause and the drum will make multiple attempts to balance the load. The timer will not resume until the final spin can be reached.

# RV/MARINE WINTERIZATION

## RV/Marine Winterization Instructions

If you're currently pumping antifreeze through your fresh water system, you can follow these steps to winterize your washing machine:

1. With machine power **OFF**, advance **cycle selector knob** to '**Lightly Soiled**';
2. Press the **Power** button once.
3. Use the Temp button to select '**HOT**'.
4. **Crack the Dispenser Drawer open** enough to confirm when antifreeze enters the drawer (approx. 1");
5. Press and hold the **START button for 2 seconds, then release**. The machine will enter a short fill, then pause. Next, it will enter a longer fill, then pause again. At this point, if you've seen antifreeze enter the Dispenser, move on to Step 6. If not, press and HOLD the **Power** button once to turn power **OFF**, then repeat Steps 2 through 5;
6. **During the pause after the SECOND fill**, press and hold the **Power** button to turn power **OFF**. The machine will automatically drain the antifreeze from the drum and then turn **OFF. FINISHED.**

To Winterize Your Washer

## To Use Your Washer Again,

1. With washing machine power **OFF**, pour bleach into both **compartment '3'** AND the **extra bleach compartment '4'** of the Dispenser Drawer, filling both to their respective max. fill levels. Do not use thickened or splashless bleach as excess suds may occur;
2. Advance the cycle selector knob to the Clean Washer cycle;
3. Press the **Power** button, then press and hold the **START button for 2 seconds, then release**;
4. Allow machine to run through the complete cycle to clean out any remaining antifreeze. **FINISHED.**

To De-Winterize Your Washer

## Clean Washer Cycle

- Prior to using your washer for the first time, we recommend running an EMPTY  'Clean Washer' cycle.
- Use **ONLY regular liquid chlorine bleach** (not splashless, because it contains detergent). Fill both chambers '3' and '4' to max. levels.
- **IMPORTANT: NEVER USE DETERGENT IN THIS CYCLE. USING DETERGENT IN THE CLEAN WASHER CYCLE WILL DAMAGE YOUR MACHINE**

## Special Drying Tips

- **For mixed loads**, remove items that tend to wrinkle while still damp (dress shirts, etc.) Hang them. Then, continue drying the rest of the load (underwear, towels, etc.)
- **After washing**, shake out LARGE ITEMS (pants, sheets, etc.) Loosely fold them, and place them back in the drum. Then, start a Dry cycle.
- Keep the **door closed** during the dry cycle.
- Use a **LOW SUDSING (HE)** detergent,
- Use **LIQUID FABRIC SOFTENER\*** or a detergent with built-in softeners,
- **DO NOT OVERLOAD** the drum,
- **DO NOT OVER DRY** your laundry. Moisture is what makes fabrics soft and fluffy.
- **IMPORTANT: USE ONLY 1-2 TBSP OF A LIQUID FABRIC SOFTENER PER LOAD. NEVER USE FABRIC SOFTENER SHEETS!**

## More Combo Tips

- **Don't let the laundry pile up.** Do a small load every day or two.
- Your combo is **front-loading and operates on 120V**, so cycle times may be longer than what you're used to.
- Your combo is an extremely efficient washer. You may not see water in the drum. **This is NORMAL.**
- So laundry falls easily from the drum after spin, **always use liquid fabric softener** (or a detergent with built-in softeners) for WASH-TO-DRY LOADS.

## What if my combo dryer is VENTLESS?

Your **WDC7200XCD** uses 2.5 gal. of water per hour to DRY. When the dry cycle ends, they may still feel slightly damp. **THIS IS NORMAL.** Simply shake items out and any steam will dissipate (a few seconds).

## Where is the dryer lint filter?

Your Splendide is gentle on fabrics. Since it generates very little lint, there's no dryer filter to clean. **However, for vented (WDV2200XCD) combos**, please go outside periodically to check the dryer vent for proper airflow and to remove any lint you see.

**You'll reduce your carbon footprint and get outstanding results in your Splendide**, when you use our specially formulated, all-natural HE laundry powder (Splendide Premium Laundry Powder, #1005). Available direct from Splendide at 1-800-356-0766.

**Splendide**  
*Laundry Centers*  
www.splendide.com